

## Pressure Gauges - Glycerine Filled

Application: Measurement of the pressure of fluid liquids or gases up to 25 bar that are not highly viscous, subject to crystallisation or corrosive to copper or tin alloys. Particularly suitable for applications where oscillating or surge pressures are present and for mounting on equipment subject to severe vibration. Designed for panel mounting bracket or 3 hole mounting flange.

### Bottom Connection

Size 63mm dia Type 7211 Connection 1/4 BSP

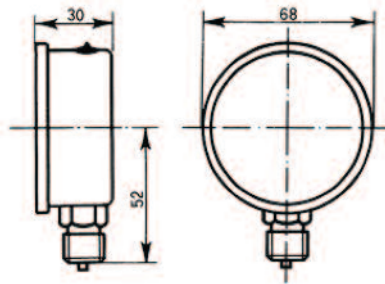

### Back Connection

Size 63mm dia Type 7217 Connection 1/4 BSP

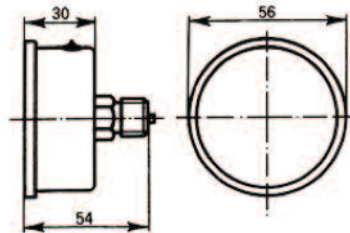

### Back Connection with Clamp Ring

Size 63mm dia Type 7217

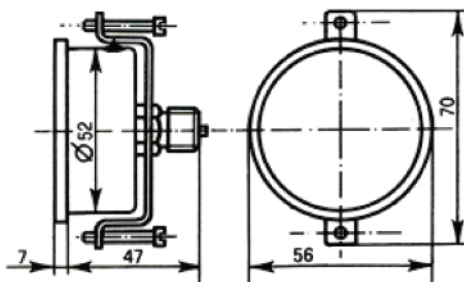

### Ranges

| psi   | Bar |
|-------|-----|
| 15    | 1   |
| 160   | 11  |
| 400   | 28  |
| 600   | 41  |
| 1000  | 70  |
| 1500  | 103 |
| 2500  | 172 |
| 4000  | 275 |
| 6000  | 414 |
| 8500  | 600 |
| 10000 | 700 |

### How to Order

63 - 7211 - 414

Diameter ————|

Type ——————|

Range in BAR ————|

### Technical Data

#### Materials

Case and Bezel: Stainless steel AISI 304  
Window: shatter resistant acrylic  
Damping Liquid: Bidistilled glycerine  
Dial: Stoved enamel on aluminium

#### Connections

Brass for pressure up to 600 bar

#### Sensitive Element

Copper alloy Bourdon tube; phosphor bronze for pressure from 100 to 600 bar

#### Mechanism

High precision watchmakers brass

#### Joints

Soldered in tin alloy or silver alloy for pressure above 60 bar

#### Indicator

Tempered steel

#### Accuracy

Class 2.5

#### Scale

Dual psi (outer) + bar (inner)

#### Notes

Also available 50mm diameter

Gauges are also available with stainless steel 3 hole front flange mounting

## Pressure Gauges - Glycerine Filled

Back Connection with welded back flange  
Size 100mm dia Type 7211F



### Ranges

| psi   | Bar  |
|-------|------|
| 3625  | 250  |
| 5800  | 400  |
| 14500 | 1000 |

### How to Order

100 - 7211F - 400  
 Diameter ————  
 Type ————  
 Range in BAR ————

## Pressure Gauges - Dry - For Air and Gases

Application: Suitable for air and gases. An economical range of pressure gauges, ideal for FRL's, regulators and compressors. Fitted with glass windows, they become an ideal option for paint spray equipment.

### Bottom Connection

Size 43mm/53mm/63mm dia Type R Connection 1/8 BSP



### Back Connection

Size 43mm/53mm/63mm dia Type P Connection 1/8 BSP



### Back Connection with 3 hole mounting flange

Size 43mm/53mm/63mm dia Type F Connection 1/8 BSP



### Technical Data

#### Materials

Case: Steel, copper ally or stainless steel  
 Wetted Parts: Brass block, bronze tube  
 Dial: Stoved enamel on aluminium

#### Connections

Brass 1/8 BSP

#### Sensitive Element

Bourdon tube

#### Connection Entry

Bottom, centre entry

#### Indicator

Tempered steel

#### Accuracy

2.5%

#### Mounting

Direct, Panel clamp fix, Panel 3 hole front

#### Range

VAC up to 12 Bar

### Ranges

| psi | Bar |
|-----|-----|
| 60  | 04  |
| 90  | 06  |
| 150 | 10  |
| 180 | 12  |

### How to Order

MO53 - P06  
 Diameter ————  
 Type ————  
 Range in BAR ————